

Kempsford

(with Whelford, Dunfield and Dudgrove)

Parish Newsletter

November 2021



Lest We Forget

KEMPSFORD PARISH COUNCIL

Clerk: Teresa Griffin, Winterwood, Whelford, Fairford, Glos. GL7 4EB

Tel: 01285 713691 Email: clerk@kempsfordparishcouncil.net

www.kempsfordparishcouncil.net

Parish Councillors	Email	Tel.
Mr Mark Strange (Chair)	markstrange@kempsfordparishcouncil.net	01285 810635
Mr Tony Williams (Vice -Chair)	tonywilliams@kempsfordparishcouncil.net	01285 810628
Mr Jerry Stokes	jerrystokes@kempsfordparishcouncil.net	07834 369645
Mrs Christine Nugent	christinenugent@kempsfordparishcouncil.net	01285 810306
Mr Philip Nickson	philnickson@kempsfordparishcouncil.net	07801 295331
Mrs Karen Saunders	karensaunders@kempsfordparishcouncil.net	01285 713155
Mr John O'Connell	johnoconnell@kempsfordparishcouncil.net	01285 810512

PARISH COUNCIL MEETING DATES

Tuesday 16th November 2021 at 7.45pm, Kempsford Village Hall

Tuesday 21st December 2021 at 7.45pm, Kempsford Village Hall

Tuesday 18th January 2022 at 7.45pm, Kempsford Village Hall

**Please note that the next edition is a combined
DECEMBER & JANUARY NEWSLETTER**

Copy for the above Newsletter to Teresa Griffin by

MONDAY 22ND NOVEMBER 2021 PLEASE

Email: clerk@kempsfordparishcouncil.net

PARISH COUNCIL NEWS

Open Parish Meeting

Thank you to all that attended the recent Open Parish Meeting in October. It was nice to meet face to face and also to hear the varying comments of the community.

The majority of comments related to roads, speeding, footpaths and future development, so no surprises there!

The Parish Council is continuing to explore the idea of producing a Neighbourhood Development Plan (NDP) as we strongly believe this is the way to shape the future of the Parish. Perhaps the next step would be a new Parish Questionnaire given that it is several years since the last one was carried out and many people have moved in to the Parish.

NDP's are not produced by Parish/Town Councils, but by the whole community. It would be great if a few members of the community have the time and drive to move this forward. External funding and technical support is available in addition to support from the Parish Council. If anyone is interested in learning more please contact the Parish Clerk.

Volunteer Newsletter Distributor needed and thank you

If you can help deliver the monthly Parish Newsletter to properties around Tuckwell Road, Holford Crescent, Wakefield Close and Northen Close (approx. 50 copies), please contact the Parish Clerk.

The Parish Council wishes to thank Jim and Margaret Hussey for all their help over many years delivering newsletters, and wish them all the very best for their move.

Another parking reminder

Further to the notice in last month's newsletter regarding the complaint received from a resident regarding parking along Top Road, which was restricting visibility when accessing their drives, we have now received complaints from residents in Chapel Close, off Top Road, who are now finding visitors are parking in the Close blocking access to their drives and restricting access for deliveries, please ask visitors to find alternative parking rather than obstructing access in Chapel Close, thank you.

Kempsford Village Hall booking for the month

	Sunday	Mondays	Tuesdays	Wednesdays	Thursdays	Fridays	Saturdays
AM		10:00 - 11:00 Pilates Rona Bennett 01865 820754		12:00 - 13:00 Pilates Janice Koo			9:00 - 11:00 Yoga Charlie McKenna
PM		15:30 - 16:30 Rainbows Caroline Gooch			12:00 - 14:00 Post Office		
Evening			20:00 - 21:00 Yoga Charlie McKenna (Except 3rd Tuesday of month)	19:00 - 20:00 Pilates Rona Bennett 07885 991673	15:30 - 17:00 Brownies Philippa Griffin 01285 810754/ 0779 3562704		
	20:00 - 21:00 Yoga Charlie McKenna		19:45 - 21:45 Parish Council Meeting (monthly, 3rd Tuesday)	20:00 - 21:30 Village Hall Meeting (monthly, 2nd Wednesday)	20:00 - 21:00 Meditation Shilpa		

CAN YOU HELP?

KEMPSFORD VILLAGE HALL urgently needs new committee members due to the 'retirement' of some long-standing members.

Can you spare a few hours a month? Do you have ideas for new village events or fundraising?

If so please contact one of us - email infokempsfordvillagehall@kempsford.net.

*Hannah Dickens, Chair

*Joy Cross, Secretary

*Amy Durban, Health & Safety
Rev Kim Brown

*Mark Britt, Vice-chair

*Mel Denny, Bookings
Secretary

Louise Edwards
Karen Saunders, Parish
Council Rep.

** Denotes Trustee*

*Jo Colson, Treasurer

*Kate Collins

Louise Jeffrey, Safeguarding

IF YOU WISH FOR YOUR VILLAGE HALL TO CONTINUE TO SERVE
THE COMMUNITY PLEASE DO CONSIDER JOINING US.

TEMPORARY ROAD CLOSURE FOR CARRIAGEWAY RESURFACING

The High Street and Chapel Road will be closed between the hours of **09:30 and 15:30** for approximately 6 days (excl. weekends) from **Thursday 4th November to Thursday 11th November** for resurfacing works - see map below.

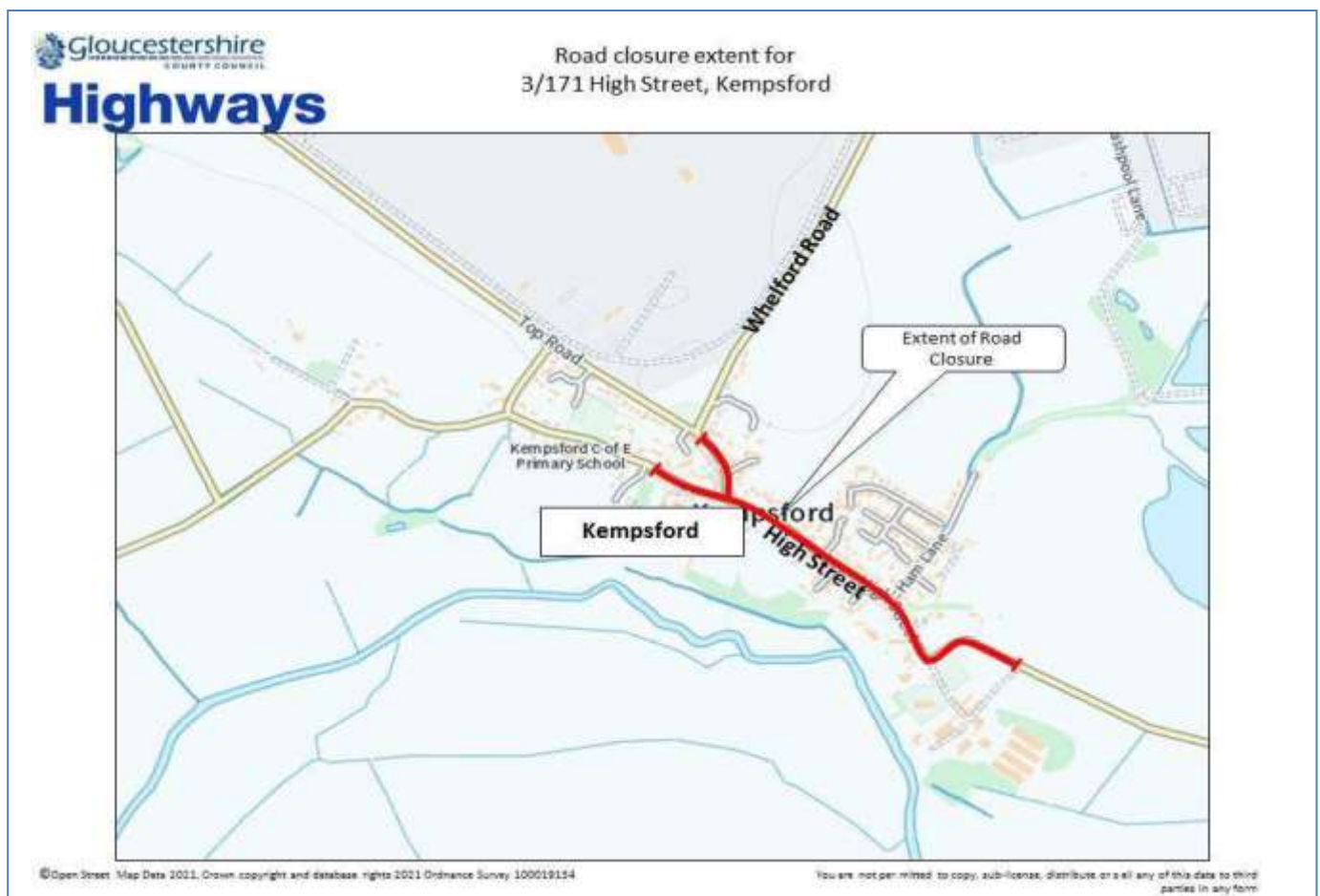

The resurfacing programme is dependent on several factors. If there are any changes to the above dates , information will be provided on the following Website – www.gloucestershire.gov.uk/resurfacing or signs in the area.

Thank you in advance for your patience and co-operation. If you have any queries please email us at highways@gloucestershire.gov.uk or telephone 08000 514 514



KEMPSFORD VILLAGE HALL CAFÉ
Thursday 11th November 12 – 2pm

Come and try our Homemade Soups and Bread,
Delicious Cakes,
Fresh Coffee and Speciality Teas.

Chat with old friends and make new.
Enjoy the friendly atmosphere and keep the village
and its hall alive!

Covid-19: To keep you and our volunteers safe
please sanitise your hands as you enter the hall
and wear masks at all times inside,
unless you are seated and eating.

***Christmas Soirée Saturday 4th December at 6pm in
Kempsford Church***

I am delighted to return to Kempsford Church this year, to showcase the wonderful talent amongst the children from the Parish. Everyone welcome to enjoy an evening of song and seasonal refreshments.

Sharon Elliott

For those that receive their newsletter in time...



HALLOWEEN

Family Cafe

SATURDAY 30TH OCTOBER

**From 12 till 3pm
At Kempsford Village Hall**

SERVING LUNCH, CAKES, TEA AND COFFEE

SPOOK TACULAR FUN AND GAMES
FOR CHILDREN
FANCY DRESS WELCOME

VOLUNTEER RECRUITMENT

Kempsford Brownies is going from strength to strength, having doubled our numbers since July, we are proud to have 17 girls now.

Our Brownie unit has been in the village since 1948 - that's over 70 years!

We are looking for new volunteers to join our team. Helping with Girlguiding is very rewarding and you get to meet new friends, learn new skills and make a difference to the lives of girls in the community.

Kempsford Brownies currently meets on a Thursday 3.30-5pm in the village hall.

To register your interest, please visit www.girlguiding.org.uk

Girlguiding is the UK's leading charity for girls and young women.
Join our team of 100,000 volunteers in the UK.

Volunteer with us

Inspire girls in your area
by just being you!

You could
volunteer with
Brownies
Age 7+

You could
volunteer with
Rainbows
Age 4+



Our events,
adventures
and meetings
empower girls to
be their best
and become
confident.

 [facebook.com/girlguidinguk](https://www.facebook.com/girlguidinguk)

 @Girlguiding

 @Girlguiding

 0800 169 5901

You could
volunteer with
Rangers
Age 14+

Your local Girlguiding contact is..

Philippa Griffin
0779 3562704

Guiding is totally flexible. Every commitment counts, there is no level of commitment too small. You have the power to change the lives of girls and young women. You don't need any Guiding experience.

You could
volunteer with
Guides
Age 10+



You could
support Guiding
in a local
area!

To find out more visit www.girlguiding.org.uk/interested

ST MARY'S KEMPSFORD WITH ST ANNE'S WHELFORD

Contact details for the parish

Rev Kim Brown - 01285 810954 or revkimbrown10a@gmail.com

Lay Preacher – Rob Mitchell 01285 712821

Church wardens: Elizabeth Emberson dizzylizzie@sky.com

or Keith Howlett - 01285 712268 keith.howlett1@btopenworld.com

or there is a Facebook page The 5 Villages

November

Autumn is in full flow and the leaves will soon start to fall gently down. The last of the apples are in crumbles in the freezer and my damson gin is distilling in the Kilner jars. (This is not entirely a peaceful country idyll however - am I the only one hiding under the bed when the bombers thunder overhead?!) Our peace of mind can be disturbed by the fuel shortages, driver shortages, and Christmas shortages, but the repeatable cycle of nature reminds us that life still goes on as the seasons change – there is abundance in the fields and wildlife find plenty to store away for their hibernation.

The Bible tells us that God always feeds the birds and will also provide for our needs too.

I suppose there's a difference between our needs and our wants! Perhaps the shortage of items will help us reduce our consumption and lists of wants in favour of a simpler way of life, now that all the extras are not so readily available. Reducing our consumption is one way of allowing our planet to breathe, to recover herself as we take less, produce less and waste less.

I'm sure all of us are thinking of ways to help reduce our carbon footprint - at home, at work, at school and at church we are hopefully doing what we can to use less energy and water, and certainly less plastic in every area of life. We are working with our school and parish council on ideas to make our village greener, and we need to reduce the plastic items in our graveyard. They break down and the plastic microfibres get into the water courses, and the solar lights impact nocturnal creatures. We will offer bulbs to be planted on graves instead to have a show of colour all year round. There was a public meeting in October to share these proposals.

It was wonderful to be at the re-opening of the village café in the village hall recently and meet locals and guests from other areas, munching on homemade soup and **bread, enjoying the array of cakes and one another's company. Thanks to everyone** who made such a happy atmosphere and drew people together after such a long time apart. Being together is so important for our wellbeing – as of course is cake, one of the major food groups!

November is our month of remembering and everyone is invited to light a candle in memory of their loved ones at a service for All Souls on Monday 1st November at 7pm at the church, and to remember our fallen heroes at a short outdoor service in the graveyard on Remembrance Sunday 14th Nov at 10.45am.

With love, Rev Kim.

CHANGES TO THE GRAVEYARD

As part of our efforts to reduce our environmental impact and improve our **green spaces, we need to make some changes in our graveyard at St. Mary's.**

We need to ask everyone

who has a loved one in the graveyard to take away plastic flowers and ornaments from the graves as they have grown in number and are damaging the environment.

The Diocese of Gloucester sets the regulations for all churchyards in our area and they do not allow any plastic flowers or ornaments – these rules have been in force for a long time and anyone who applies to have a loved one buried or interred in our churchyard has to sign to say they will adhere to them.

However, some people have said they have never been made aware of this and so I list the regulations here (a copy of the full document is in the noticeboard in our church porch and this is found on page 12):

Flowers

- 8.1 Except where the design of a memorial/gravestone includes an integral vessel for plants or cut flowers, flowers may only be placed in a removable container. Wreaths and cut flowers may be placed in such containers or laid on any grave, but must be removed as soon as they appear to be withered or dead.
- 8.2 Artificial flowers are not allowed except for Remembrance Day poppies and traditional Christmas wreaths. They should be removed after no more than two months.
- 8.3 The PCC may, at its discretion, at any time remove and dispose of wreaths, cut flowers or artificial flowers placed in a churchyard if it is considered that, in the PCCs reasonable opinion, they have deteriorated and/or have become unsightly.
- 8.4 Bulbs and small annual plants may be planted in the soil of any grave (but not in any container). However, no trees or shrubs may be planted without the agreement of the PCC and the consent of the Archdeacon.
- 8.5 The PCC may make rules for the location and removal of flowers and a copy of such rules shall be made available both to the family of the deceased before any burial or the interment of cremated remains and should generally be available for perusal in the church porch or other suitable position in the churchyard where they may be freely consulted by members of the public. [These are listed in the noticeboard in the church porch].
- 8.6 A parish priest, churchwarden or whoever is authorised by the PCC to look after the churchyard is permitted to remove unsightly flowers and any items not permitted by these Regulations and any other permitted items if they consider they are not maintained to an acceptable and tidy condition.

- 8.7 One suitable toy or tribute may be placed on the grave of a child (i.e. a person under 18 years of age) provided that it is removed after a period of six months. No ornaments or additions may be placed on other graves save for flowers or wreaths as provided in this Regulation 7.

Why do we need to make these changes?

1. As there was no Vicar in post for 5 years, the number of items on graves has grown and grown. They are harming the environment and look unsightly.
2. We are working to care for the environment and the plastic and painted items are very harmful to the land, water and wildlife we share the countryside with. The plastic breaks down and pollutes the land and local streams, and the solar lights at night are harmful to nocturnal creatures.
3. A country graveyard, next to a Grade I listed church should look appropriate to its setting; peaceful and natural.
4. The church and the parish council have received many complaints from people whose loved ones are in our graveyard and who object to the amount of items on graves. They are adhering to the regulations and wish others to do the same.

Some people have said they do not wish to be buried here themselves because of all the items on the graves. This is a shared public space and everyone must be aware of the impact of their actions upon others.

What are we proposing?

We are asking you to take home personal items, plastic and ceramic items and solar lights from the graves and make a space at home or in your garden for them instead. You can choose one thing to keep on the grave, as long as it is not a solar light of any kind.

In exchange, we will be offering bags of mixed bulbs, free of charge, that can be planted on the graves, so there will be colourful flowers coming out all year round, improving the area for bees and insects, and returning the graveyard to a more natural country environment.

If you are unable to plant bulbs, we have a team of people who are experienced gardeners from the village who will plant them for you, with your permission.

A new group to oversee the graveyard

A group of people from the village have formed to work on improvements to the graveyard. We will be installing a new bench and planting some wildflower areas, as well as bulbs and plants for bees and insects over the next few months. If you would like to join this group, please contact Mark Strange from our parish council, number on the rear cover of this newsletter.

Rev'd Kim Brown, Vicar and Mr Mark Strange, Chair of Parish Council

St Mary's, Kempford with St Anne's, Whelford
Church Services

Sunday 7 November	9.30 am Kempford	Holy Communion
Sunday 14 November Remembrance Sunday	10.45 am Graveyard, Kempford	A service of Remembrance with choir
Sunday 21 November	9.30 am Whelford 4 pm Kempford	Holy Communion Family Service
Sunday 28 November First Sunday in Advent	9.30 am Kempford	Holy Communion

Dates for your diary

Saturday 23rd October 10.30am-**11.30am at St Mary's church** – come and collect a shoe box to fill with Christmas gifts for a child in need or drop off any items to donate to shoe boxes, and have a coffee.

Monday 1st November at 7 pm. All Souls Service to remember all those we love who are no longer with us.

Saturday 6th November. Last day to return all Christmas shoe boxes for Team4U **either to St Mary's Kempford or to Rosemary Andrews so that they can be sent on.**

Morning Prayer continues to take place, via The 5 Villages Facebook page, every weekday at 8 am. **St Mary's is now open every** day for prayer and reflection. St **Anne's** is open on Fridays for prayer and reflection.

Thank you all for your generous contributions to the Food bank during the Harvest Services. Altogether 28.85 kg of food was collected. Collection boxes are in place in **the porches at both St Mary's and St Anne's and are emptied** regularly. Items that are particularly in short supply at the moment are: tinned fish, soup,, meat pies and longlife juice and milk.

We are looking for another Foundation Governor to serve our village primary school on its Governing Body. If you are a Christian with some experience in the education sector and some spare time, please contact Rev Kim Brown on 01285 810954 to see if this is a role for you.



Aggregate Industries has the safety of the communities it operates in at heart. As such we must stress to those living close to our Manor Farm Quarry site that it is of paramount importance that they stay out of the quarry. Below are just a few examples why:

- Within the site there are steep, hidden holes which can contain deep, cold water which can cause shock and result in drowning. They potentially have unstable sides which can prevent people from escaping them if they fall in
- While the base of the quarry may look sturdy, it may be made of soft clay which can collapse if walked on
- Dangerous quicksand is present within the quarry.
- Trespass at the weekends when there are few or no staff on site might mean there is no help available if required

While we will **always look out for our neighbours' safety**, it is also important that our neighbours look out for the safety of each other.

Warning signs close to the site have recently been vandalised, resulting in the potential hazards being unclear to passers-by, and fences have also been **damaged meaning people and animals can access areas where they shouldn't** be. We respectfully ask that our neighbours report any vandalism that they see around our site so we can keep the community and our colleagues safe.

We thank you for your cooperation, and we look forward to continuing safe operations in the area.

Budget Consultation

4 October - 19 November 2021

WE WANT YOUR VIEWS



Fill out our survey at
cotswold.gov.uk/budget



COTSWOLD
DISTRICT COUNCIL





**FRIENDS OF FAIRFORD & LECHLADE
COMMUNITIES**

(Reg. Charity No: 1180059)

YOUR LOCAL CHARITY

Serving Fairford, Lechlade and the surrounding village.

(Formerly League of Friends of Fairford Hospital)

News and Information from your Community Friends



**DATE FOR YOUR DIARY – 13TH NOVEMBER 2-5pm
CHARITY CRAFT FAIR LECHLADE MEMORIAL HALL**

A whole host of festive stalls for you to enjoy. Light refreshments will be available. A great afternoon out with FREE tattoos and a craft area for all children.

All stalls are now sold, if anyone would like to go on a cancellation list then please get in touch. We look forward to seeing you there on the 13th. For further information please contact Val Harvey voluntarycarservicelof@gmail.com or on 07540798226.

The very popular Friends of Fairford & Lechlade Raffle will be drawn at the above event. Tickets are on sale now, available at our Charity Shop in Lechlade, Southrop Coffee Morning (every Wednesday) and at Lechlade Garden Centre on 6th November. You can also get Raffle Tickets by emailing gm@friendsoffairford.org.uk. Prizes from Thyme, Bibury Trout Farm, Cotswold Wildlife Park, Cutler & Bayliss The Bull, Fairford Therapy, Eastleach Downs Organic Farm and many more.

NEW ADMINISTRATOR REQUIRED

Friends of Fairford & Lechlade Communities are recruiting for a new Administrator to start in the New Year. Our current Administrator will retire at the end of December. If you are interested in the role, or know of someone who might be, please send a c.v. to Fairford.lof@hotmail.co.uk or get in touch with Christine Barker on 07767 408409 for an informal chat.

COULD YOU HELP OUT IN OUR CHARITY SHOP

Unfortunately, we have seen a loss of some of our previous volunteers following the pandemic. We are looking to increase our volunteers to ensure we can maintain the friendly customer service and much sought-after facility we provide through our charity shop in Lechlade. If you, or anyone you know could help, please visit the shop, call 01367 252189 or email Fairford.lof@hotmail.com

**Please note that you can now drop off donations any day the shop is open
no appointment necessary.**

Monday Closed All Day: Tuesday-Friday 9.30am-3.45pm: Saturday 9.30am- 1.15pm

**COVID-19 COMMUNITY FUNDING SUPPORT – REMAINS OPEN FOR
APPLICATIONS**

The Community Friends' Covid-19 Support Fund established to provide financial support to local organisations, charities, volunteer groups, families and individuals who have been impacted by Covid-19 remains open for applications. To date the fund has provided grants

exceeding £77,000 to local individuals, organisations and charities. Please refer to our website for details of how to apply and the criteria we use to assess applications (www.friendsoffairford.org.uk).

VOLUNTEER DRIVERS NEEDED URGENTLY

Our team of volunteer drivers provide a lifeline to many in our community who need to get to their medical appointments at the GPs and hospitals. With appointments opening again we urgently need more drivers to help with this vital community service. We ask our volunteers to complete a DBS check as this service provides much needed support and assistance to many vulnerable people in the community. Car running costs are paid for.

If you think you can help, please contact Val Harvey on 07540 798226 or email Val at voluntarycarservicelof@gmail.com

With thanks for all your support. Please refer to our website www.friendsoffairford.org.uk for more information about the Community Friends

Shelley Welsh, Chair

Friends of Fairford & Lechlade Communities (Reg. Charity No. 1180059)

Interest in Basketball Club?

You may be aware of the Multi Use Games Area opposite the school in the village.

I have had the idea of starting a basketball club on this area.

If we can interest enough people (above eight preferably) we can begin playing in the Spring.

No previous experience is necessary and I can provide coaching/ refereeing.

Please contact Roger West (rogerwest2019@icloud.com) for more information and to register an interest.

Kempsford Angling Club.

This is to inform you that I am expecting to leave the village in the near future. However, paid up members can continue to fish until the season ends on the 14th of March. In fact, we still have some vacancies left for the next 5 months and for those who like Chub fishing, I can really recommend it, my best so far this season being 5lb8oz.

For further information, please call Jim Hussey on 810446.

Walk 9: Horcott and River Coln

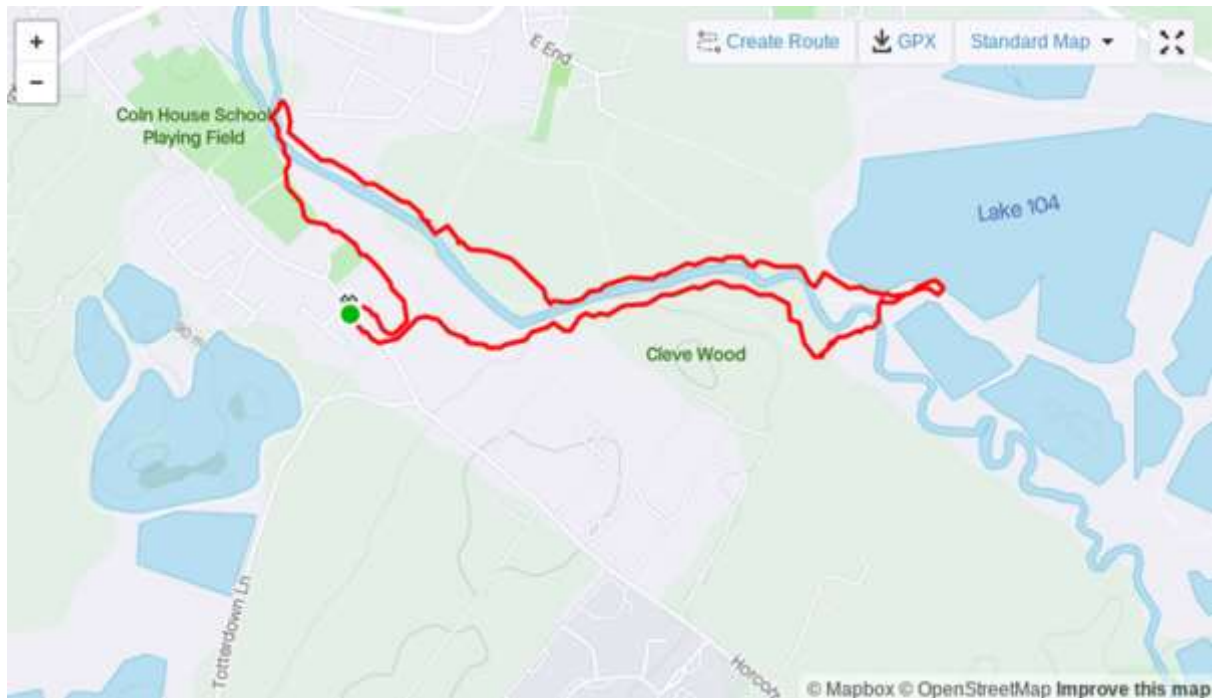

Distance **2.27mi**

Moving Time **1:01:17**

Pace **26:59/mi**

I am getting short of routes to walk now, but I will claim this did at least start in the parish even if I did drive to the start which was by Horcott House (Pic 1). Walk up the farm drive and then turn right and go between some buildings with a house on your left. It does look as if you are going to end up in someone's back garden, but don't panic, you will soon see the



stile into a grassy field (Pic 2). Follow the path arrows - and there are lots of them tacked onto fence posts and bridges. You will get your first view of the Coln on your left (Pic 3) and Cleeve Wood on your right. If the wood wasn't there you would probably be able to see part of the airbase (the "not the main entrance" side). At the end of the

field take the bridge and there are some trees to get under (Pic 4), which did bizarrely remind me of the limbo dancing we did on the Kempford Cricket Club tour all those years ago to the Isle of Wight. Still as they say what happens on tour stays on tour.



If you survive that bit, the territory opens up and you should be able to see another bridge which is a bit more elevated and requires climbing a few steps to get onto. At the end of this you are still under halfway, but sensing victory I went to the right and walked by the imaginatively named Lake 104 (pic 5). Something is happening at this lake (more holiday lodges?) so I soon found the Heras fencing which was open and would have allowed access. For me it was the turn around point, else I couldn't have got back to the start on footpaths (and would have ended up near the water ski lake).



So having turned around, go effectively straight ahead, and find another bridge on your left. Having crossed that, go right. At this point I met a local who helped me on my way. Of all the walks so far, this is the most people I have met. I think this is possibly encouraged by the buggy/wheelchair friendly accessibility path which we get to after about 3 open fields. Pic 6 shows a sign at the point we join the accessibility path - also instructions on helping the Coln water vole population.

The weather was kind today and I didn't need the gloves I had brought - this was as a result of having cold hands the day before at The Hawthorns, home of West Bromwich Albion. Many of you will know this is the highest football league ground in the country and I should have known better. I digress because on our right is a field of lethargic looking cows who reminded me of the Bristol City defenders as West Brom scythed through their defense for the first goal. Enough rambling on and back to the excellent made up path that takes you to Dilly's bridge - now a shiny galvanised version in case you haven't been there for a few years. Use this to cross over the Coln. I stopped to talk to a couple of Fairford water vole spotters, no luck today though for them. There was a very friendly cat also looking out so that may explain it. They told me they have seen up to 7 cats on "vole-patrol". Having crossed the bridge turn left and walk back along the Coln with the Fairford Youth Football ground on your right. You will come to a split in the path at a wooden fence. If you take the right hand option it will bring you out by the Catholic church. I took the left option which brings you back to the farm track where you go right to finish the walk. As usual the photos will look better on the KPC website - as well as being in colour!



So a short walk but a pleasant way to spend Sunday afternoon.

Richard Caswell

Village Organisations & Useful Contacts

Vicar	Rev Kim Brown	revkimbrown10a@gmail.com	01285 810954
Church Wardens	Keith Howlett	Keith.howlett1@btopenworld.com	01285 712268
	Elizabeth Emberson	dizzylizzy@sky.com	
Church Choir	Mrs Cathy Stanford		713033
Church Bells	Iris Lewis		810770
Kempsford School	Mr Richard Mendum	(Head Teacher)	810367
Chairman of School Governors	Darren Jeffrey	chair@kempsford.gloucs.sch.uk	810875
Farmors School	Mr Matthew Evans (Head)		712302
Kempsford Village Hall Bookings	Mel Denny	villagehallbookings@kempsford.net	0734 1901986
Whelford Village Hall & bookings	Sue Griffin	374croft@gmail.com	712979
Kempsford Angling Club	Mr J Hussey		810446
Kempsford Brownies	Philippa Griffin	https://www.girlguiding.org.uk/	
Cricket	Anthony Axel-Berg		07766222951
Royal British Legion	Mr A Hill		810035
Soldiers, Sailors & Airman's Acc.(SSAFA)	Mr & Mrs A Hill		810035
Scottish & Southern Electricity			0800 072 7282
Thames Water			0800 316 9800
Non-emergency Police Contact			101
NHS 111 Service		(when less urgent than 999)	111
Environment Agency	Floodline—0845 9881188	General Enquiries -	03708 506 506
Bulk Refuse	(phone to book)		01285 623000
Highway Matters & Street Light Faults		highways@gloucestershire.gov.uk	08000 514 514
Kempsford Hand Bell Team (Beaubells)	Iris Lewis		01285 810770
Cotswold District Councillors	Steve Trotter	Steve.trotter@cotswold.gov.uk	07710 405323
	Stephen Andrews	Stephen.andrews@cotswold.gov.uk	01285 719924
Cotswold District Council			623000
Gloucestershire County Council			01452 425000
		Out of hours <u>Social Care issues only</u>	01452 614194
Gloucestershire County Councillor	Mr Dom Morris	Dominic.morris@gloucestershire.gov.uk	07500894702
Constituency MP	Sir Geoffrey Clifton Brown	cliftonbrowng@parliament.uk	01242 514551
Parish Council Clerk (see Parish Council page for Councillors)	Mrs Teresa Griffin	teresagriffin@kempsfordparish Council.net	0781 8626158
Newsletter items	Mrs Teresa Griffin	As above	0781 8626158
Kempsford Website		www.kempsford.net	
Kempsford Parish Council Website		www.kempsfordparishcouncil.net	

Kempsford

Online



'Kempsford Village'
'Kempsford Mums & Dads'